

USER INSTRUCTIONS

MODIFICATION OF UNIVERSAL 12V WIRING HARNESS (LFDLH) TO SUIT APPLICATIONS THAT DO NOT REQUIRE HIGH BEAM SWITCHING.

The logo for Light Force, featuring the brand name in a stylized, italicized font. A horizontal yellow bar is positioned above the word "Light".

Light FORCE®

INSTALLATION STEPS

1. Shorten the brown trigger wire (Item D in Figure 1) and connect to wire (Item C in Figure 1). This will allow the lights to function without the need of the highbeam lights being active.

Fig 1. Driving Light Harness

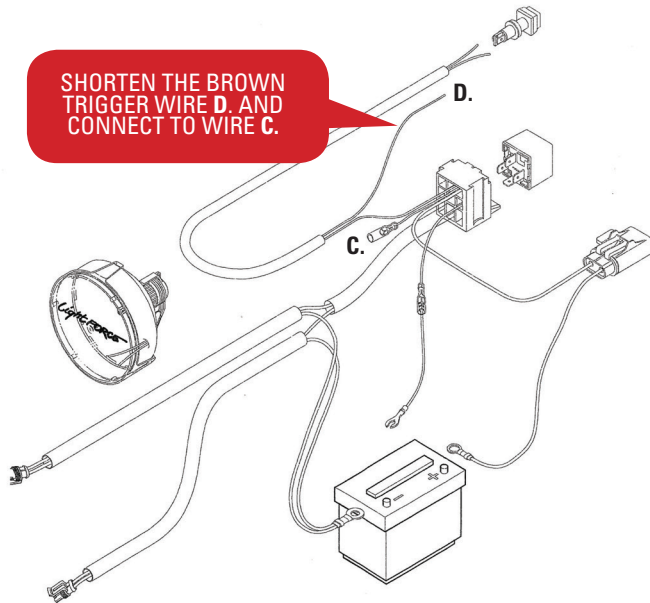



For warranty information and to register your product for warranty purposes, visit lightforce.com/warranty

LIGHTFORCE PERFORMANCE LIGHTING INC.

336 Hazen Lane, Orofino ID 83544 USA

www.lightforce.com • Email: sales@lightforce.com

International Telephone: +61 8 8440 0888 | Fax: +61 8 8346 0504

All logos and images are subject to relevant trademark and copyright protection. Copyright © Lightforce Australia Pty Ltd 2019. Data and specifications may be subject to change without notice. Lightforce Australia Pty Ltd shall not be liable for damage, malfunction, failure resulting from accident, misuse, misapplication, unauthorised repair, neglect, modification, unauthorised or non standard replacement parts, accessories, bulbs, batteries or voltage or operation of the product beyond its technical and or environmental specification.