

INSTRUCTION DATA

PRODUCT: **35W/50W HID**

VER: **1.1**

DATE: **JANUARY 2012**



35W/50W HID USER INFORMATION

INSTALLATION

It is important that the light be mounted on a flat surface that supports the base fully and is isolated from excessive vibration. It is equally important to ensure there is adequate clearance between the rear of the light housing and any vehicle structure to allow freedom of movement in the event of impact. A spacer kit is included, this includes 2 x 6mm spacers for raising the light from its mounting point.

Carefully tighten the mounting bolt to 50ft/lbs. DO NOT over tighten. Be particularly careful if using a spanner or wrench with greater than normal leverage.

It is a good idea to have your electrical wiring relay with the terminals facing down, this will help protect the relay from water spray damage. Ensure correct polarity by connecting RED to (+) positive and BLACK to (-) earth. If you are unsure PLEASE contact a qualified auto electrician. If the cable supplied as standard is not long enough, ensure that you use the correct diameter cable to extend the wiring harness.

Note: 12V 150 mOhm lead resistance

For the HID bulb replacement (Part No: HIDBULBASS) please refer to the instructions below.

WIDE ANGLE FOCAL SPACER RING INSTALLATION

The Lightforce DL240 HID 35/50-watt driving light can be refocused to suit your individual driving style.

By changing or removing the supplied aluminium spacer rings it is easy to refocus the beam from an ultra long distance spot through to a wider angle providing a larger spot size with reduced distance. Due to the immense light output of the Lightforce 35/50W HID, the maximum distance is usually still more than adequate for most driving needs when set up for wide angle.

Further to this the use of a unique Lightforce COMBO clip-on filter provides even greater versatility, when used in conjunction with a spacer ring a very broad medium range pattern can be achieved. If you have any queries please seek the expert advice of your LIGHTFORCE dealer or email our customer services department - tech@lightforce.net.au.

Lightforce 50W HID comes standard with the 2mm spacer ring fitted.

- The 2mm spacer ring will provide a good combination of long distance with a beam of approximately 9.8° spread.
- By inserting the 2.8mm spacer ring **only** a broader beam is obtained of approximately 11.8° spread
- By removing spacer ring completely a longer narrower beam pattern is obtained with approximately a 6.5° spread.

IMPORTANT INFORMATION

1. ALWAYS switch off the lamp unit and disconnect from the power supply before any work is performed.
2. It is important to allow the bulb to cool after operation before proceeding any further.
3. Remove the entire unit from the vehicle and place face down onto a stable, clean soft surface to avoid damage to the lens or filter, this will also minimise the possibility of dropping the spacer ring into the back of the housing.
4. Evenly remove the four allen head bolts (2.5mm) from the access plate. **Note:** there is a large spring behind the plate. Remove plate with spring attached.
5. Note placement of rubber gasket to ensure same installation upon refitting.
6. It is advisable to wear safety glasses and gloves when removing the bulb from the holder. **NEVER** touch the bulb itself or any glass surface, hold bulb by its base only (if contact is made, clean glass with alcohol wipe). Gently grasp the bulb unit and carefully withdraw from the housing with the input wire connected, be sure not to damage the insulated electrode on the light housing.
7. **If changing spacer ring:** Insert the spacer ring into the bulb seat. **Go to Step 9.**
8. **If changing bulb:** disconnect the metal plug (with wire) from the square bulb assembly (Do not twist or bend the connector, this may cause damage). Fit new bulb assembly to terminal and reinsert assembly feeding the power wire back into the housing at the same time.
9. Refit the bulb back into the globe seat, feed the power wire back into the housing at the same time.
****ENSURE the bulb is seated squarely into the globe seat****
10. Refit rear access plate making note that the rubber gasket is positioned correctly and the screws are evenly tensioned to ensure that the housing remains sealed.

LIGHTFORCE AUSTRALIA PTY LTD • 28 Orsmond Street, Hindmarsh SA 5007 Australia • www.lightforce.com | email: info@lightforce.net.au
Australia: Tel: 08 8440 0888 | Fax: 08 8346 0504 • Int'l: Tel: +618 8440 0888 | Fax: +618 8346 0504

All logos and images are subject to relevant trademark and copyright protection LIGHTFORCE Pty Ltd | © Jan 2012 • Data and specifications contained maybe subject to change without notice.

LIGHTFORCE AUSTRALIA Pty. Ltd., shall be not be liable for damage, malfunction, failure resulting from accident, misuse, misapplication, unauthorised repair, neglect, modification, unauthorised or non standard replacement parts, accessories, globes, batteries or voltage or the operation of the Product beyond its technical and environmental specifications.

COMPONENT BREAKDOWN

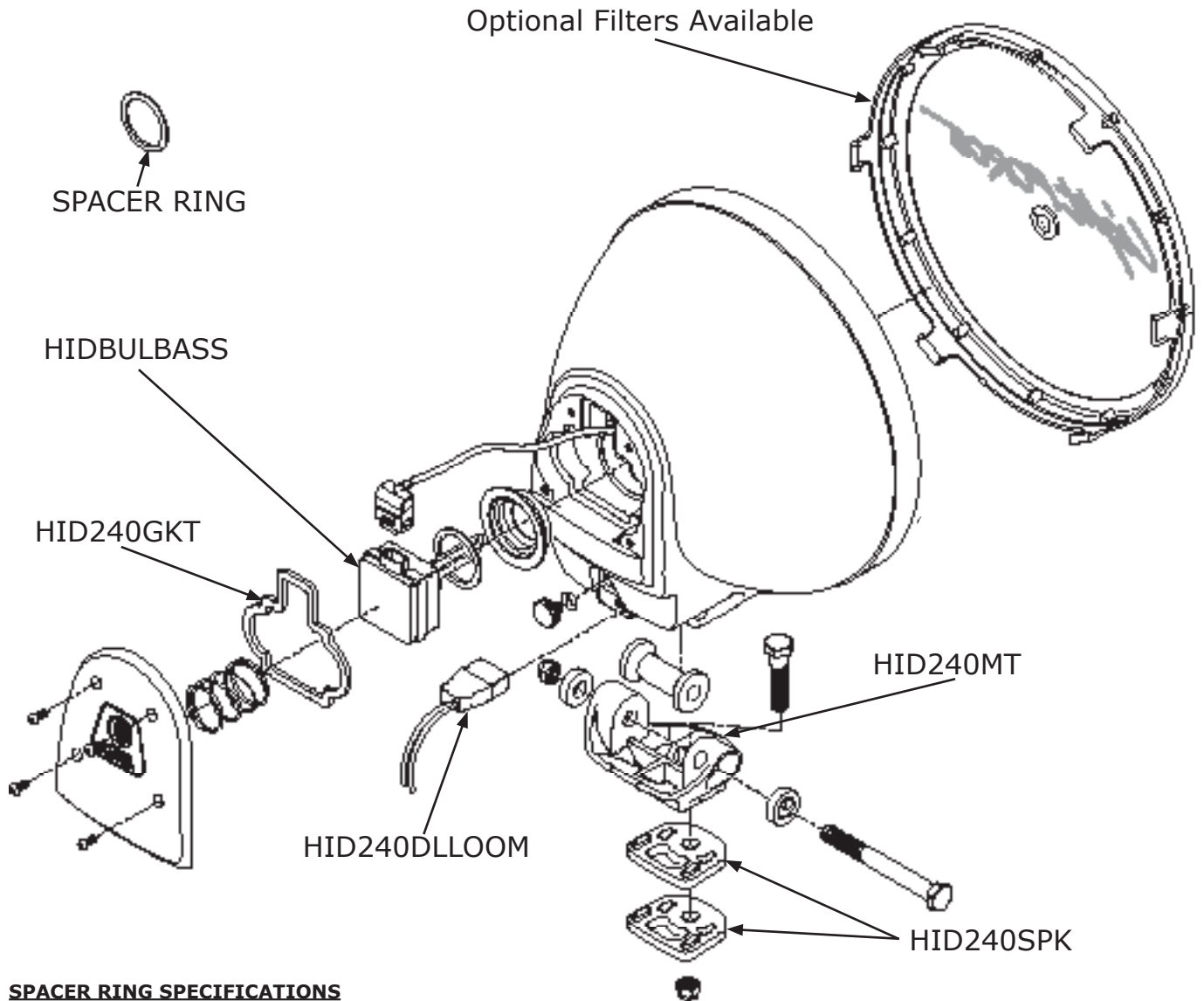

SPACER RING SPECIFICATIONS

Beam Angle:

No Spacer	= approx 6.5°
2.00 mm	= approx 9.8° (factory fitted in 50W HID)
2.8 mm	= approx 11.8°

This light is designed to be run with a clear cover at all times, this helps prevent damage to the front lens. Other filters are available for specific purposes. If you have any further questions please consult the LIGHTFORCE driving light brochure, or contact your local LIGHTFORCE dealer or email us at HID@lightforce.net.au